

## LIGHT STEEL VILLA CONSTRUCTION





2440 Hurontario St. Mississauga ON Canada :: 1647 708 2529 :: [nabia@alynaglobal.com](mailto:nabia@alynaglobal.com)



Light Steel keel



## COMPONENTS DE WALL, ROOF AND FLOOR

Internally Installed pipe and cable maximise make your space. Insulation layer, Fibre Cement Board, board and insulation board give you good heat and sound insulation. House wrap and plaster board help you to adjust the humidity to create a comfortable space for you

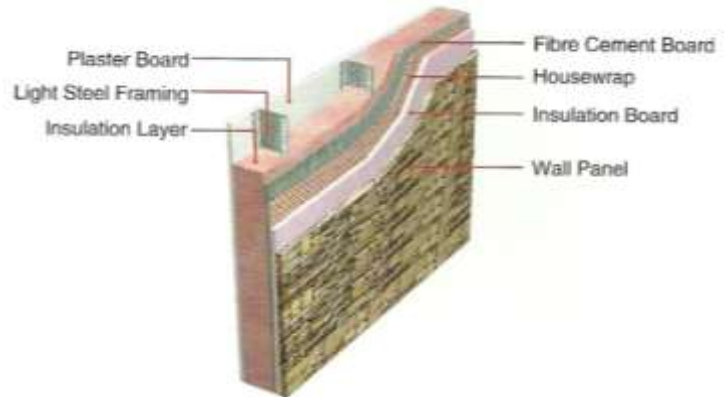

Internally Installed pipe and cable maximises the height of the room. Insulation gives you good heat and noise insulation. Fibre cement board combined with super structure ensure the villa is solid and durable

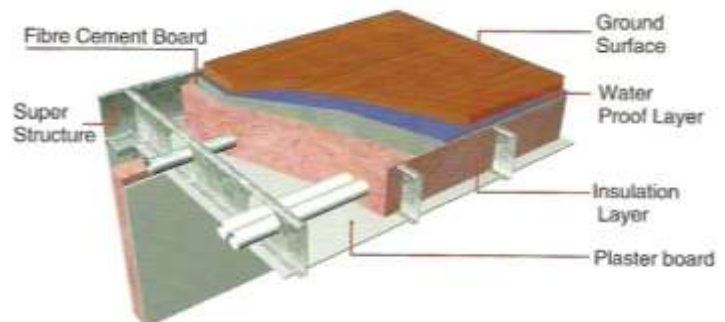

The unique interlayer design is rainproof and durable. The special ventilation circulation system ensures the fresh air for you at any time.

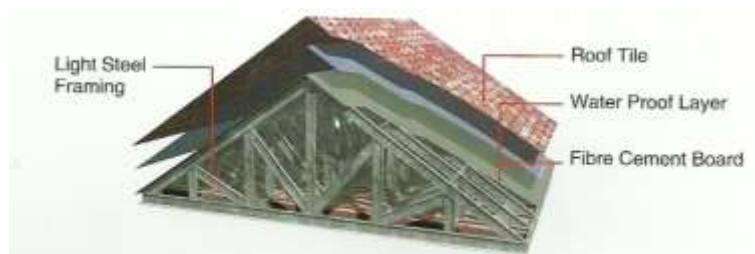

Dimensions Length 10140mm x Wid 8940mm Fittings Main Bedroom, Second bedroom, Bathroom, kitchen, Corridor, canteen room

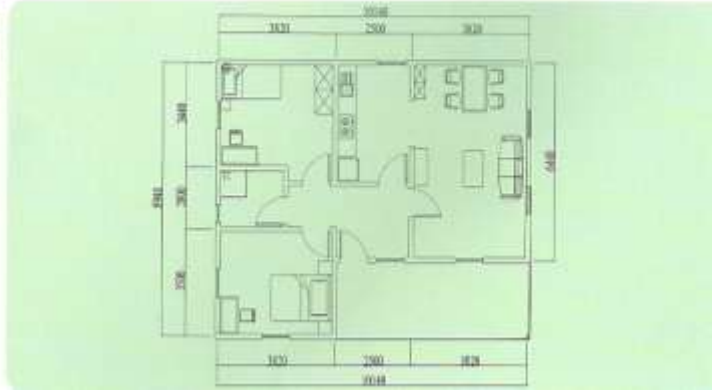

## MATERIAL SPECIFICATION

Metope and floor, roof steel framework	90seriesC-style light steel keel (Q350 galvanized steel)
Roof panel	75mm glass insulation wool+12mmOSB panel one-way breathing paper+0.5mm colored glazed tile
Exterior wall panel	+ 75mm glass insulation wool + one-way breathing paper + 27mm metal carve patterns PU sandwich panel
Internal wall panel	75mm EPS Sandwich panel, the thickness of colored steel are both 0.42mm/0.42mm (upper and down); Density is 12 kg/m <sup>3</sup>
Indoor hang ceiling structure	12mm plaster slab board+75mm glass insulation wool



Outdoor hang ceiling structure	10mm OSB board		
outer door-1	960*2050 steel door		
interior door-1	750*2100PVC moulded door		
interior door-2	800*2100PVC moulded door		
window	Aluminium alloy double glazing window		
Cost for fittings			
Hardware fittings	Expansion anchor bolts, normal anchor bolts, etc.		
Lighting system	switches, sockets, 1 distribution box		
water pipes			
PVC eaves gutter			
PVC Rainspout			
Windows, doors, overclock etc. aluminum alloy line			
40ft HQ container	<b>80- 100 M2</b>		
<b>Average Price</b>	USD	M2	<b>\$530</b>



# CEMENTITIOUS STRUCTURAL INSULATED PANELIZED HOUSE

## CEMENT STRUCTURAL INSULATED PANELS (CSIPS)

1. As an alternative to the traditional wooden skin SIPs (Structural Insulated Panels), CSIPs is more suitable for areas with high humidity and severe pest problems. CSIPs act as the frame, sheath and insulation at the same time, which greatly increase construction speed, save on onsite labor cost and result in a more energy efficient and cost effective system.

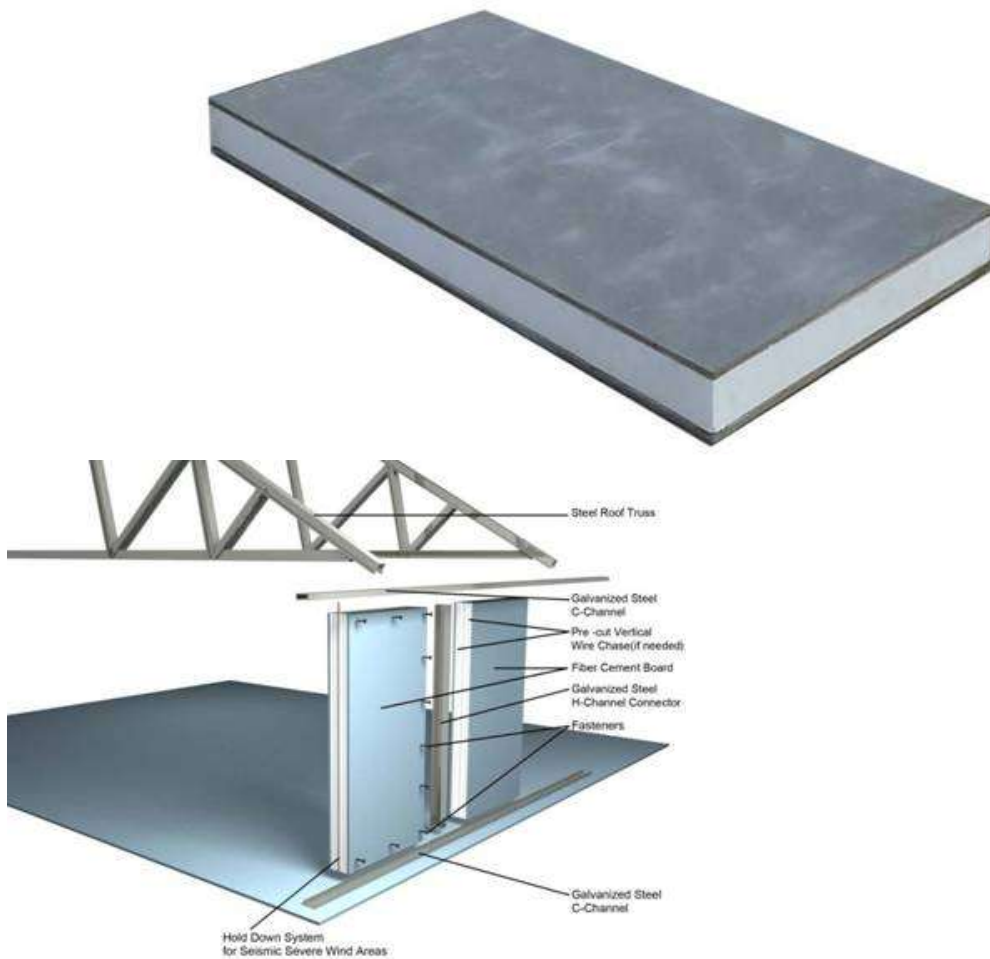



2440 Hurontario St. Mississauga ON Canada :: 1647 708 2529 :: [nabia@alynaglobal.com](mailto:nabia@alynaglobal.com)





## 2. Light Gauge Steel Roof Truss

### 3. Using the world's best fully automated cold roll forming machine, we offer light gauge steel truss for roofs and floors with the following characteristics:

- Fully engineering data
- Virtually unlimited truss design - extremely versatile
- Chords and webs in one plane
- Lightweight and easily handled on-site
- Strong weak axis performance - helps prevent damage in handling, reduces bracing requirements, and provides solid footing for installers and other trades
- High strength to weight ratios
- Long span capabilities
- Mechanically fastened - no welding
- Layout, design and engineering, and fabrication drawings accomplished with state-of-the-art software

Material: High tension Galvanized Light Gauge steel, G550

Thickness: 0.55mm/0.75mm/1.0mm,

2440 Hurontario St. Mississauga ON Canada :: 1647 708 2529 :: [nabia@alynaglobal.com](mailto:nabia@alynaglobal.com)



## **MATERIAL SPECIFICATION**

### **Part for steel structure**

- Steel column (Q235B)
- "A" shape beam for roof (Q235B)
- Connect material for steel structure (Q235B)
- M12 Pull rod (Q235B)
- Ring beam (Q235B)
- Geosyncline (Q235B)
- Free Support (Q235B)
- Purlin for roof (Q235B)

### **Part for wall and roof**

- UPVC tile for roof 1040X50
- Fastigium tile
- Concrete villa panel for external wall 100mm
- Concrete villa panel for interior partition wall 100mm
- Coating material for external wall
- Coating material for external wall interior partition wall
- Aluminium alloy window or plastic-steel window
- Steel door (800x2000)
- PVC door for toilet (800x2000)
- Steel door (800X2000)



## Decoration sheet

- Decoration sheet for eave (color steel sheet)
- Decoration sheet for gable wall (color steel sheet)
- Decoration sheet for door and window (color steel sheet)

## Accessories

- Galvanize screw M12
- Screw for foundation 'M14
- Self-tapping screw 'M5
- Rivet  $\phi 4 \times 12$
- Other accessories

## Other fee

- |                                  |        |
|----------------------------------|--------|
| • Packing fee for sandwich panel | 1.0%   |
| • Loading fee                    | 1.0%   |
| • Management fee                 | 3%     |
| • Profit                         | 5.00%  |
| • Tax                            | 21.00% |

**Average Price(USD/m<sup>2</sup>)      USD                      \$580**

Remarks:

- The price above doesn't include the cement foundation, electric, ceiling and other decoration part.
- One 40'HQ can load 80-100 /M2.
- The above price is valid for 15 days.



## ABOUT SIPS.

### For a quick idea:

SIPs stands for structural insulated panels. They are high performance thermal efficient composite panels which consist of a sandwich of two layers of structural board with an insulating layer of foam in between for walls, roofs and floors in new residential and commercial buildings. Building with these panels are stronger, faster, better insulated, more energy efficient and more cost effective.





**ALYNA GLOBAL**  
CREATING A DIFFERENCE



Canada-11



Canada-12



Canada-17



Canada-18

2440 Hurontario St. Mississauga ON Canada :: 1647 708 2529 :: [nabia@alynaglobal.com](mailto:nabia@alynaglobal.com)



2440 Hurontario St. Mississauga ON Canada :: 1647 708 2529 :: [nabia@alynaglobal.com](mailto:nabia@alynaglobal.com)



## **Structure & Insulation:**

All exterior wall panels by SIPs, Roof by SIPs or L.G. steel truss and all exterior wall panels by SIPs or 2\*4

All post and beam needed, Subfloor by 15/18mm T&G OSB, SIP screw/glue/type/Basic SIP tools

Row stair.

## **Roofing & Downspout:**

1-Roof Asphalt Paper (#30 ASTM), Asphalt shingles (if metal with stone coated, add \$7/m<sup>2</sup>), (If clay tile or roof state, add \$ 16M<sup>2</sup>) (if asphalt roll with stone coated)

2- Soffit and Fascia by PVC or Cedar Metal Flashing, Gutter and Downspout by Owens Corning.

## **Exterior Wall:**

House wrap (#15 ASTM), Nichina fiber cement panel siding, brick tiles, or culture stone.

(Cedar log siding: add \$9),

## **Interior/Wall/ Ceiling / Flooring:**

Drywall: 12.7mm Gypsum Board

Ceiling: 12.7mm Gypsum Board, (Vertical SPF Panels: add \$9)

Solid Wood Composite Flooring.

## **Doors:**

Exterior door: Wooden/ Steel Door

Garage Door: PVC Panel Door

Interior Door: Solid wooden door, ball lock

Closet door: Solid wooden door

## **Windows:**

Windows: PVC double Glaze, Low-e, argon filled

Thermal bridge break Aluminium with wood cladding, low-e, argon filled, add \$50 M<sup>2</sup>.

2440 Hurontario St. Mississauga ON Canada :: 1647 708 2529 :: [nabia@alynaglobal.com](mailto:nabia@alynaglobal.com)



## **Bathroom:**

Shower room: Major Brand in China

Bathtub: American Standard/Toto/Kolher

Wash Basin: American Standard/Toto/Kolher

Mirror: Entry level china brand name

All ceramic tiles: Major brand

Faucets /Shower heads: Major brand

Ceiling: Water resistant wall and roof

## **Kitchen:**

Solid wood frame; major brand

Closet: MDF

**Plumbing:** Not Included (Please provide standard /Certificate requirement)

**Fixture:** Not Included (Please provide standard /Certificate requirement).

## **Note:**

- Prices are subject to change without notice
- Shipping: All by 40' High Cubin Container, shipping cost paid by customer, 1 container can load around 80 - 100m2 of house
- Full engineering drawings before contract: USD 1000

**Average Price/M2    USD    \$730**